

# SPECIFICATION GUIDE





# ALUCO™

Steel Look Collection



## CONTENTS

<b>About Us</b> Aluco Steel Look Collection.....	<b>3</b>	<b>Aluco Interior Single &amp; Double Doors</b> .....	<b>16</b>
<b>Specification Details</b> .....	<b>4</b>	<b>Aluco Interior Sliding Doors</b> .....	<b>20</b>
<b>Key Features - Interior Single Doors</b> .....	<b>6</b>	<b>Style Options</b> .....	<b>22</b>
<b>Key Features - Interior Sliding Doors</b> .....	<b>8</b>	<b>Min &amp; Max Sizes</b> .....	<b>23</b>
<b>Double Door Lock Case &amp; Meeting Style</b> .....	<b>10</b>	<b>Gallery</b> .....	<b>24</b>
<b>Lock &amp; Hardware</b> .....	<b>12</b>	<b>The Aluco Experience</b> .....	<b>26</b>
<b>Door Closer</b> .....	<b>14</b>		

## ATTENTION TO DETAIL

Every product in the Aluco Collection is designed and built specifically for each individual customer, handcrafted by our skilled craftsmen to your exact specification. Our ethos is one of exceptional design and product performance, created to compliment the home and lifestyle of our customers. We believe in producing architectural solutions that will delight customers now, and for years to come.

Aluco have an exceptional reputation, where attention to detail and superb British craftsmanship is second to none. We specialise in the design and manufacture of iconic steel effect windows, doors and screens covering both interior and exterior applications, for truly luxe living.

The Aluco Collection is available in an extensive selection of colour and finish options, including a stunning range of traditional and contemporary hardware and ironmongery styles and designs to compliment your home.







# ALUCO INTERIOR DOOR, SCREEN AND PARTITION SPECIFICATION GUIDE

## ALUMINIUM EXTRUSION

- Aluminium construction, all frame profiles extruded from 6060 grade material
- Solid aluminium extrusion with no thermal break
- Powder coat painted finish.

## HARDWARE SPECIFICATION

- Q-lon perimeter gasket seal
- Woolpile threshold seal
- EPDM glazing gasket
- Fingerbolt supplied in 5 lengths from 150mm to 609mm
- Lock and deadbolt with 60mm back set:
  - Tested to BS EN 12209 : 2003
  - Includes grip tight follower spring
  - Includes anti-rattle strike and dust box
- One piece knuckle hinge, stainless steel pin.



## DESIGN SPECIFICATION

- 52mm (front-to-back) deep outer-frame
- 37mm wide transom bars
- 150mm wide flush lock body
- Sash threshold plate with double woolpile seal
- One piece double door locking mullion
- Square single glazing bead
- 20mm and 37mm Astragal Bars
- 5mm wide 'Dog-Bone' structural coupler.

## MANUFACTURING

- All corner joints glued and crimped with 2No aluminium cleats
- CNC machine routing for all components.

## DESIGN PARAMETERS

- Maximum single door size: 2300mm high x 1000mm wide
- Maximum double door size: 2300mm high x 1800mm wide
- Maximum screen size dependant on glass specification
  - 4mm and 6mm glass thickness options available
- 10mm floor clearance (standard)
- No outer-frame threshold for seamless floor through door
- Outer-frame threshold as an option
- Minimum 4 hinges per sash
- Side screen with 37mm mullions and 20mm Astragal bars
- One piece door and top light designs available
- Traditional flush lock-plate body
- 150mm high Deep Bottom Rail to frames and sashes
- Lock options:
  - Latch only
  - Latch and cylinder
  - Bathroom Lock
- Handle options:
  - One piece back-plate
  - Circular back plate, with separate escutcheon for cylinder and bathroom lock
- Finger bolts supplied in varying lengths dependent on door height, allows operation of finger bolt as easy to reach height.

## GUARANTEE & TESTING

- 10 year mechanical guarantee on lock
- 10 year guarantee on aluminium extrusion and finish
- 10 year guarantee on Q-Lon gasket compression
- Lock tested to Fire Test CF850
- 2 year guarantee on hardware finish for interior handles.





# KEY FEATURES

## Interior Single & Double Doors

- 1 Powder coated solid chambered aluminium extrusion with no thermal break**  
All Aluco interior doors and screens are extruded from solid aluminium extrusion with no thermal break to provide strength, rigidity. Powder coat finish to negate the need for on-going maintenance.
- 2 Flush 150mm wide lock body**  
The lock-body housing is 150mm wide with Flush design to give a traditional appearance and enhance lock housing feature.
- 3 Circular back-plate escutcheon handle ranges**  
Handle range offers circular back-plate with separate escutcheon for bathroom locks. Available in a range of finishes.
- 4 Deep bottom rail**  
One piece 150mm high deep bottom rail. Suits perfectly in frame and sash negating need for separate infill panel.
- 5 Slim 37mm transom**  
Ultra Slim 37mm transom, provides strength whilst maximising natural light and glass area. 37mm Astragal Bar to match sightlines in any side-panels.
- 6 Flush bottom sash with double wool-pile seal**  
Flush bottom sash with double woolpile seal. Neat clean finish to bottom of door with option to have draft proofing seal across bottom of door.
- 7 4mm toughened glass as standard**  
4mm clear toughened glass as standard with ability to choose laminate, all finished with square shaped bead. Option to have white laminate or Reeded obscure glass designs. Doors and screens can have single or multiple glass types in each product.
- 8 Lock with one piece keep**  
Lock with adjustable tension, dust pocket tidy and one piece keep. 65mm backset wide handle to escutcheon for easier operation and clearance.
- 9 Minimum 4 No slim knuckle hinges**  
Minimum number of 4 slim knuckle hinges, always traditionally fitted with 2 hinges at the top for greater strength.
- 10 Q-lon perimeter door seal**  
High performing Q-lon perimeter door seal with its foam core provides 99% memory recovery.
- 11 All corner joints glued and crimped**  
All corner joints are glued, double cleated with chevron fitted before being crimped to produce a strong aligned corner joint.

### Additional features

- Side-panels and Fixed lights do not require a dummy sash for 37mm Transom to line through, reducing glass sightline to 33mm.
- New slim 5mm coupler reducing coupling sightline by 65%
- Top-lights can be made as an integral part of doors.

## Interior Double Doors

Aluco interior double doors have the same features as the single door. The door meeting stile is a one-piece design for added strength and is provided with a range of finger-bolts available in a range of lengths for easier operation and reach.

## Interior Screens and Partitions

Aluco interior screens and partitions use the same core components as the doors but are manufactured with slim 33mm outer-frame, uses the standard 37mm transoms and is also available with ultra-slim 20mm Astragal bars which can accommodate various style choice. Clear and obscure glass designs are also available.







# KEY FEATURES

## Interior Sliding Doors

- 1 Powder coated solid chambered aluminium extrusion with no thermal break**  
 All Aluco interior sliding doors and are extruded from our unique solid aluminium profiles with no thermal break to provide strength and rigidity. Powder coat finish to negate the need for on-going maintenance.
- 2 Flush 150mm wide lock body**  
 The lock-body housing is 150mm wide with Flush design to give a traditional appearance and enhance lock housing feature.
- 3 Flush recessed handle range**  
 Handle range includes flush recessed for easy operation. Available in a range of finishes.
- 4 Deep bottom rail**  
 One piece 150mm high deep bottom rail. Suites perfectly in frame and sash negating need for separate infill panel. (optional).
- 5 One piece head track**  
 One piece head track with concealed gearing and soft close function.
- 6 4mm toughened glass as standard**  
 4mm clear toughened glass as standard with ability to choose laminate, all finished with square shaped bead. Option to have white laminate or Reeded obscure glass designs. Doors and screens can have single or multiple glass types in each product.
- 7 Slim 37mm transom**  
 Ultra Slim 37mm transom, provides strength whilst maximising natural light and glass area. 37mm Astragal Bar to match sightlines in any side-panels.
- 8 20mm Astragal Bar**  
 20mm Astragal Bar allowing a range of styles to be incorporated into your doors.
- 9 All corner joints glued and crimped**  
 All corner joints are glued, double cleated with chevron fitted before being crimped to produce a strong aligned corner joint.



Bottom of outer-frame with no outerframe threshold



Bottom of standard door sash threshold



Bottom of Door with deep bottom threshold



Latch Keep with grip tight and dust box



Bathroom latch and deadbolt keep with grip tight and dust box



Slim rebated knuckle hinge



Slim Structural Coupler



Single Latch Handle mounted on 110mm Flush Lock -Body



Bathroom Handle with deadbolt and separate Escutcheon mounted on 110mm Flush Lock-Body

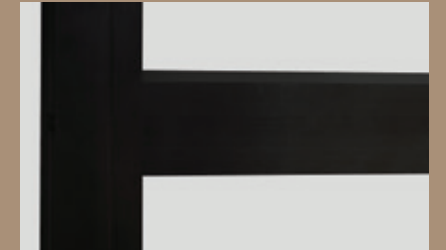

Ultra Slim 37mm Door Transom



37mm Astragal Bar to match door transom



20mm Astragal Bar



# LOCK & HARDWARE



## Single & Double Door Lock Case Product Specification

- 65mm backset
- One piece face plate keep
- Stainless steel latch bolt & dead bolt
- Grip tight follower spring
- Anti-rattle strike plate
- Keep plate dust box
- Tested to BS EN 12209; 2003
- Certifier tested - CF850
- 10 Year mechanical guarantee.

## Single & Double Door Lever Handles Product Specification

- 50 x 8mm circular Rose
- Lever handle with separate bathroom escutcheon
- Sprung handle
- Black, Satin Chrome & Antique Brass finishes.

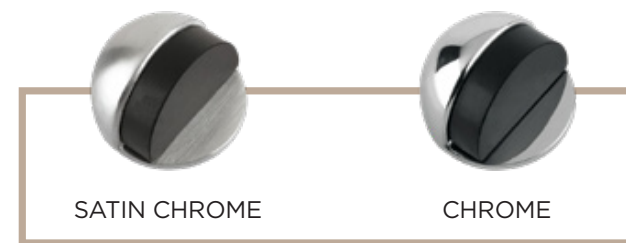
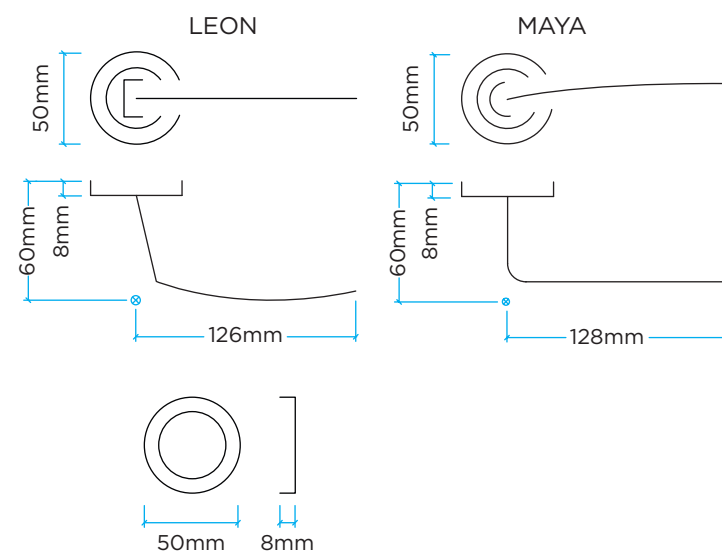

## Floor Mounted Door Stop Product Specification

- BS EN 1634-1
- 45mm dia.
- Concealed-fix
- Satin Chrome & Chrome finishes.

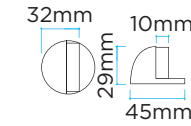

## Wall Mounted Door Stop Product Specification

- BS EN 1634-1
- 80mm projection
- Concealed-fix
- Satin Chrome & Chrome finishes.

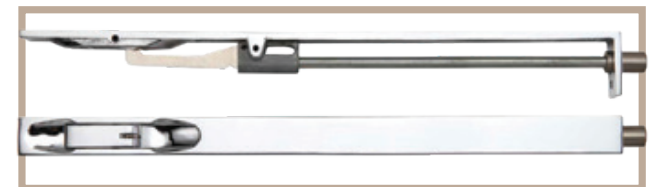
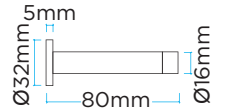

## Double Door Finger Bolt - Flush Dust Excluding Pockets Product Specification

- Wood and concrete options
- Flush Fitting.

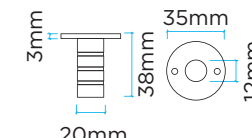
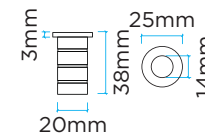

## Double Door Finger Bolt Product Specification

- Flush Fitting Finger-bolt
- Stainless steel pin, spring and fixings
- High corrosion resistance
- Positive location into mullion
- Suitable for heavy duty use
- Available in 5 sizes
  - 150mm
  - 200mm
  - 305mm
  - 457mm
  - 609mm.



## Sliding Door Handle Product Specification

- Rectangular recess pull
- 102mm x 45mm plate
- 10mm deep recess
- Flush fitting
- Black, Satin Chrome, Antique Brass finishes

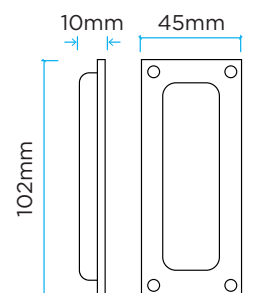

# DOOR CLOSER



## Size 3 Rack & Pinion Overhead Door Closer

### Product Specification

- Fixed power size 3
  - Suitable for doors up to 60kg, 950mm wide
  - Approved for installation on both pull-side & push-side of the door
  - Non-handed
  - Adjustable closing speed
  - Adjustable latch speed action
  - 10 year manufacturer's warranty
  - BS EN 1634
  - BS EN 1154 : 1996
- Projecting arm
- 4

8

3

1

1

3
- Black & Silver finishes.

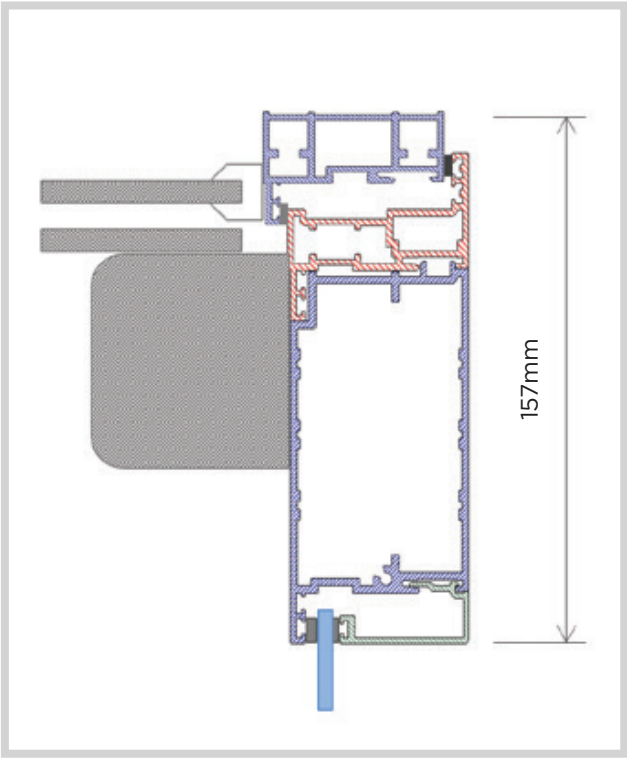
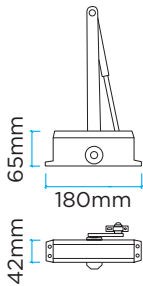

## Fire Safety – Control of the Spread of Fire and Smoke

All dedicated fire-resistant doors should be fitted with a door closer that is successfully tested to BS EN 1154.

A closed fire-resisting door is designed to withstand attack by fire for a specified period of time, installation of a door closer will ensure that the door is mechanically closed when not in use.

### BS EN 1154:1997

This is the European standard for the performance of controlled door closing devices. It uses a 6 digit coding system to give clear details on the capabilities and performance levels of what the specific door closer model has been tested and approved to.

Example 

4

8

2

1

1

4

The below detail gives the breakdown of each code:

#### DIGIT 1 CATEGORY OF USE

Grade 3: For closing doors from at least 105° open  
Grade 4: For closing doors from 180° open

#### DIGIT 2 TEST CYCLES

Grade 8 – 500,000 test cycles

#### DIGIT 3 TEST DOOR MASS/SIZE

Door closer power size	Recommended door leaf width	Test door mass	Closing moment				Opening moment between 0° and 60°	Door closer efficiency between 0° and 4°
			Between 0° and 4°	Between 68° and 92°	Any other angle of opening			
			Nm min.	Nm max.	Nm min.	Nm max.	Nm min.	Nm max.
1	<750	20	9	<13	3	2	26	50
2	850	40	13	<18	4	3	36	50
3	950	60	18	<26	6	4	47	55
4	1100	80	26	<37	9	6	62	60
5	1250	100	37	<54	12	8	83	65
6	1400	120	54	<87	18	11	134	65
7	1600	160	67	<140	29	18	215	65

#### DIGIT 4 FIRE BEHAVIOUR

Grade 0 – Not suitable for use on fire/smoke door assemblies  
Grade 1 – Suitable for use on fire/smoke door assemblies

#### DIGIT 5 SAFETY

All doors closers are required to satisfy the essential requirement of safety in use. Therefore only Grade 1 is identified.

#### DIGIT 6 CORROSION RESISTANCE

Five grades of corrosion resistance are identified according to EN 1670:  
Grade 0 – No defined corrosion resistance  
Grade 1 – Mild resistance  
Grade 2 – Moderate resistance  
Grade 3 – High resistance  
Grade 4 – Very high resistance

## Mounting Positions

### DOOR MOUNTED PROJECTING ARM, PULL-SIDE

The most common application, provides a high degree of door control and range of adjustment. The closer is mounted on the pull side of the door with the arm mounted on the frame. When the door opens the arm passes over the door.

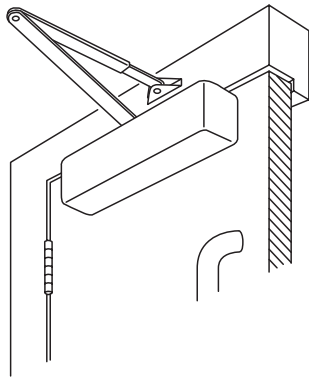

## DOOR CLOSER FEATURES

### POWER SIZE

The Power Size of a door closer is measured in accordance with the Closing Torque that is achievable on the closing cycle.

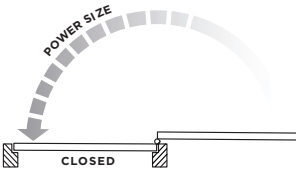

The BS EN 1154 Standard classifies closers from a Size 1 through to a size 7 and recommends the use in accordance with the door width and door mass (weight).

Power Sizes can be fixed, selectable or adjustable.

### ADJUSTABLE CLOSING SPEED

Controlled door closers offer adjustability to the speed that the door will operate, the closing speed has adjustment from the maximum opening angle through to the last 10 to 15°.

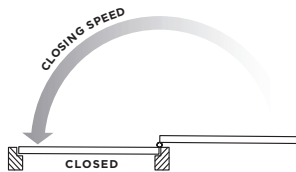

### ADJUSTABLE LATCH ACTION

This allows speed adjustability on the last 10 to 15° to assist with overcoming latches and seals.

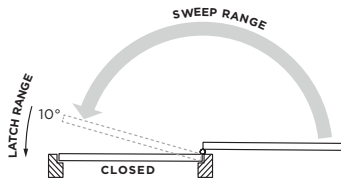



# SINGLE & DOUBLE DOORS

## Deep Bottom Rail and Double Door Lock Pocket

Both single and double doors have the option for additional design elements.

These cross sections illustrate the overall section dimensions with and without these components

## SINGLE & DOUBLE DOOR OPTION

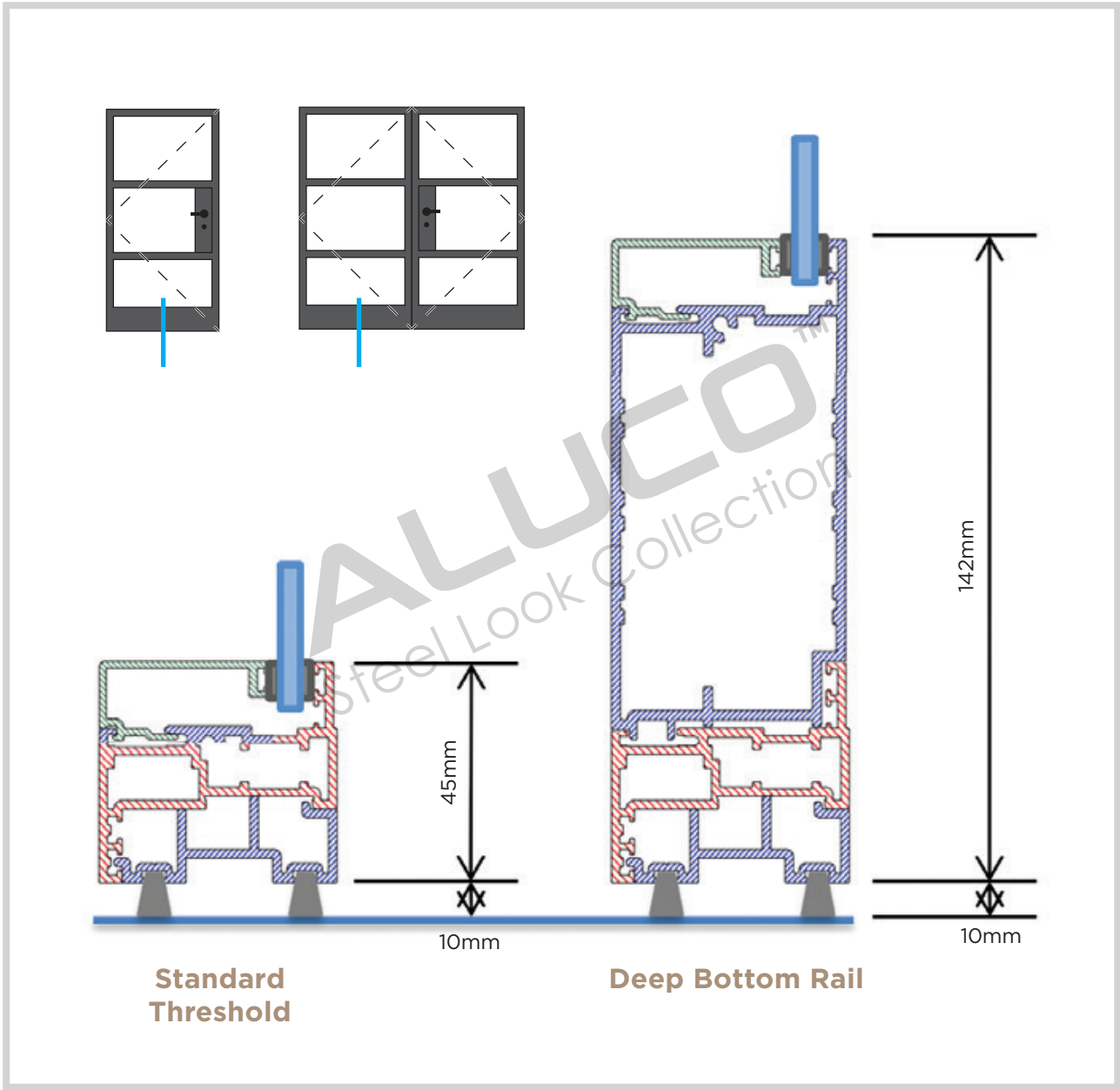

## DOUBLE DOOR OPTION

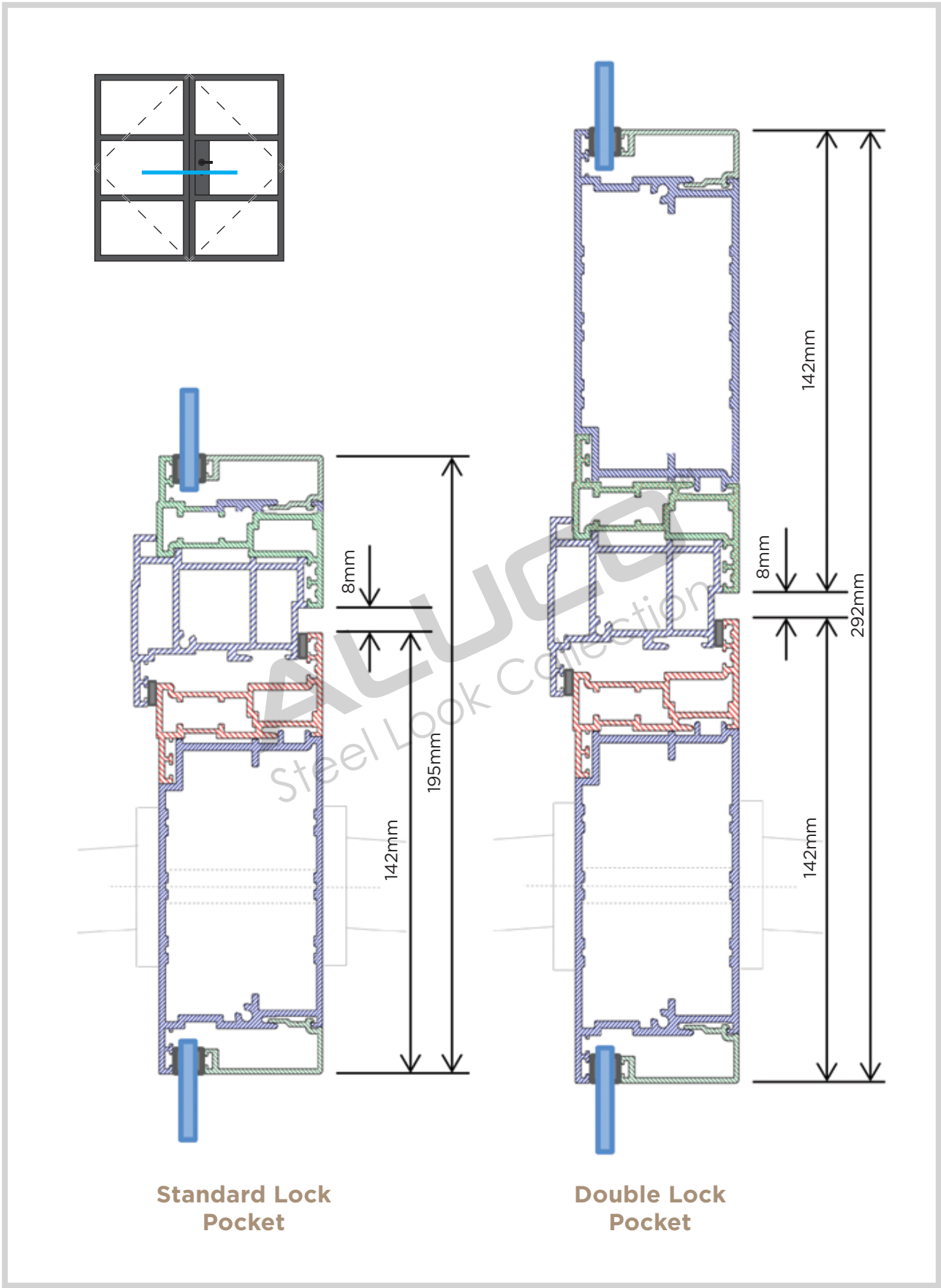

# SINGLE & DOUBLE DOORS

## CROSS - SECTION DETAILS

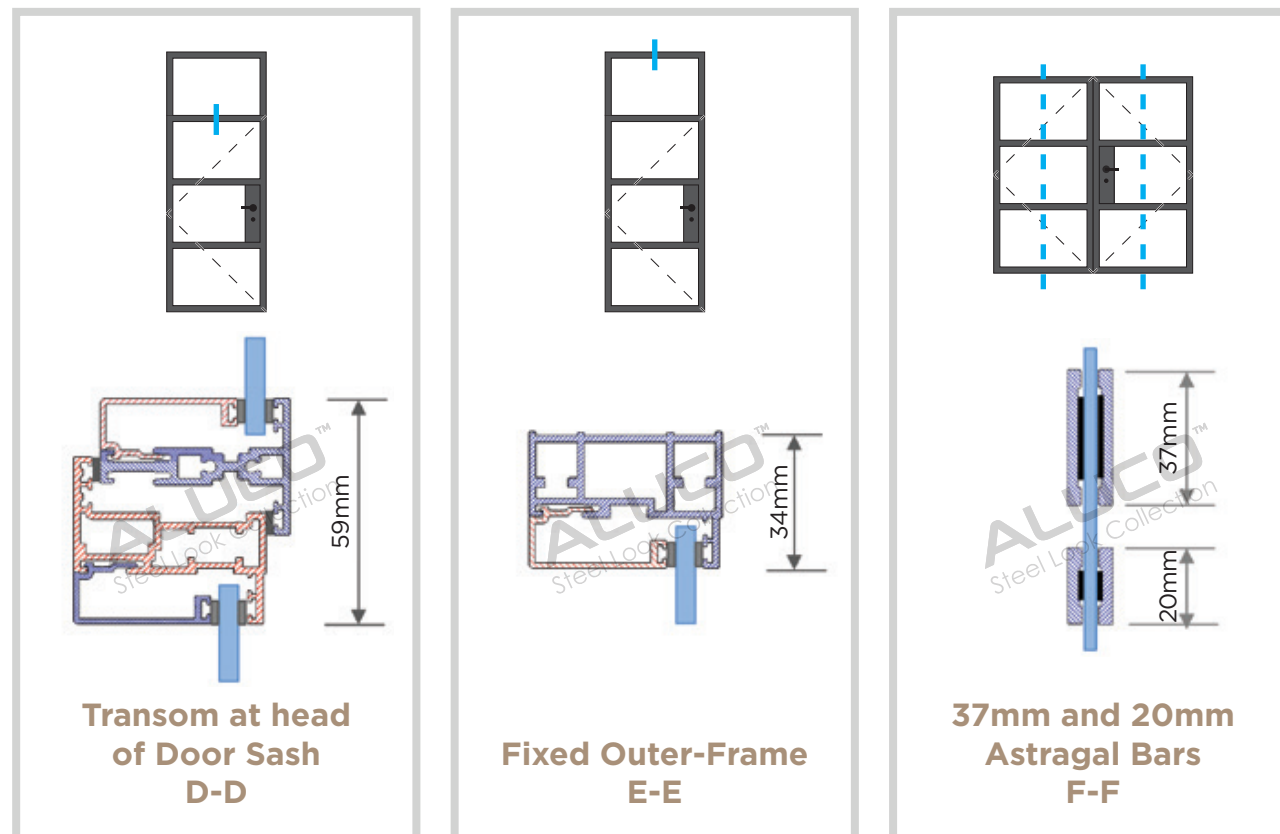
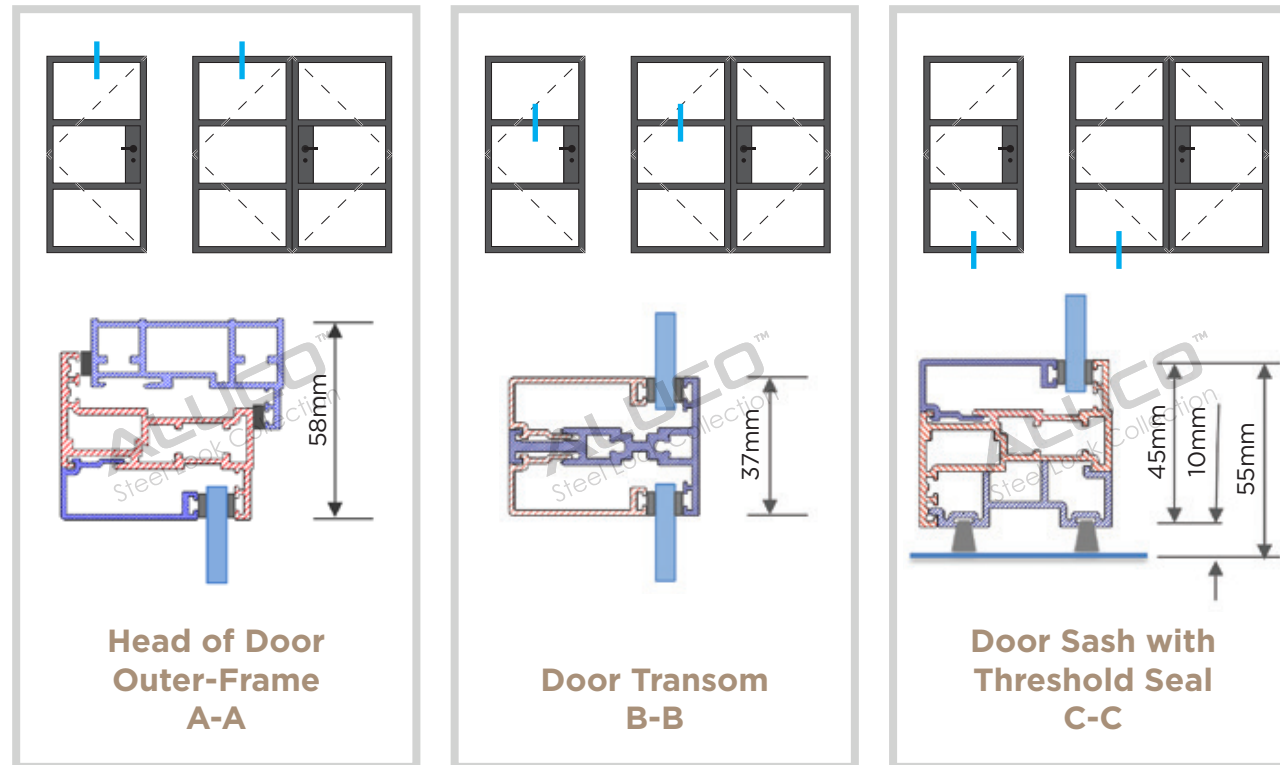

**NOTE** - Always depict Astragal Bar with dashed lines

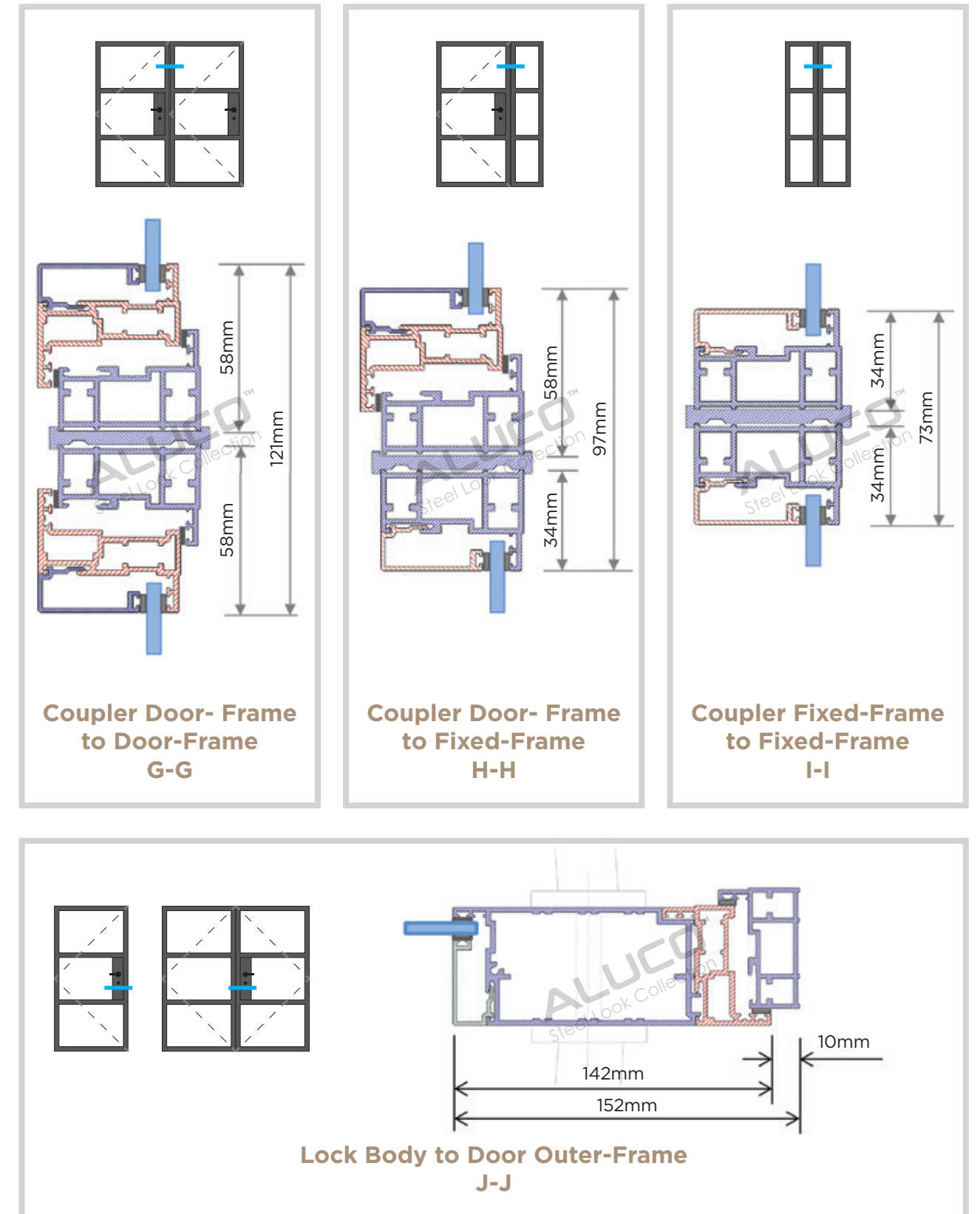



# SLIDING DOORS

## CROSS - SECTION DETAILS

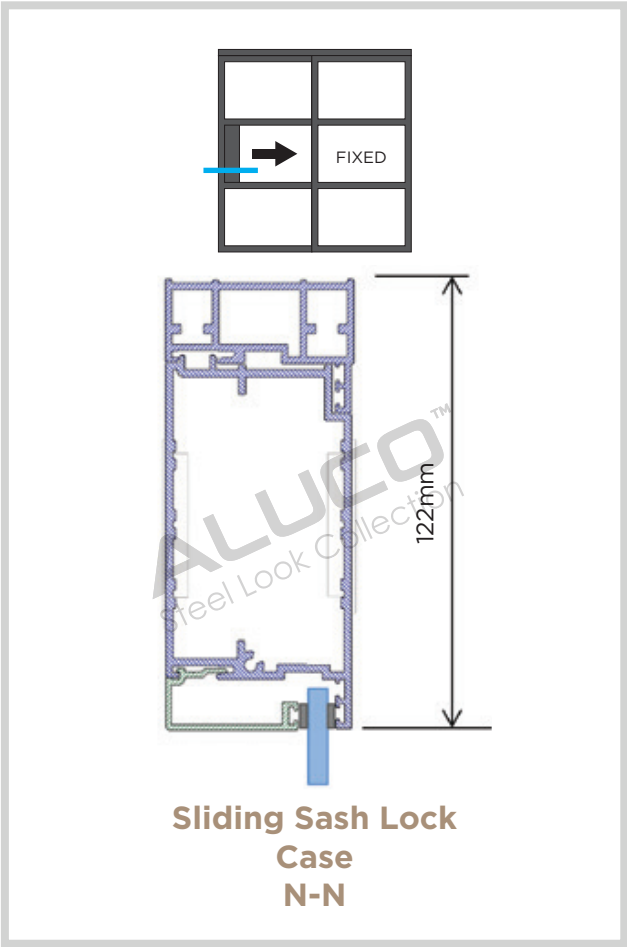
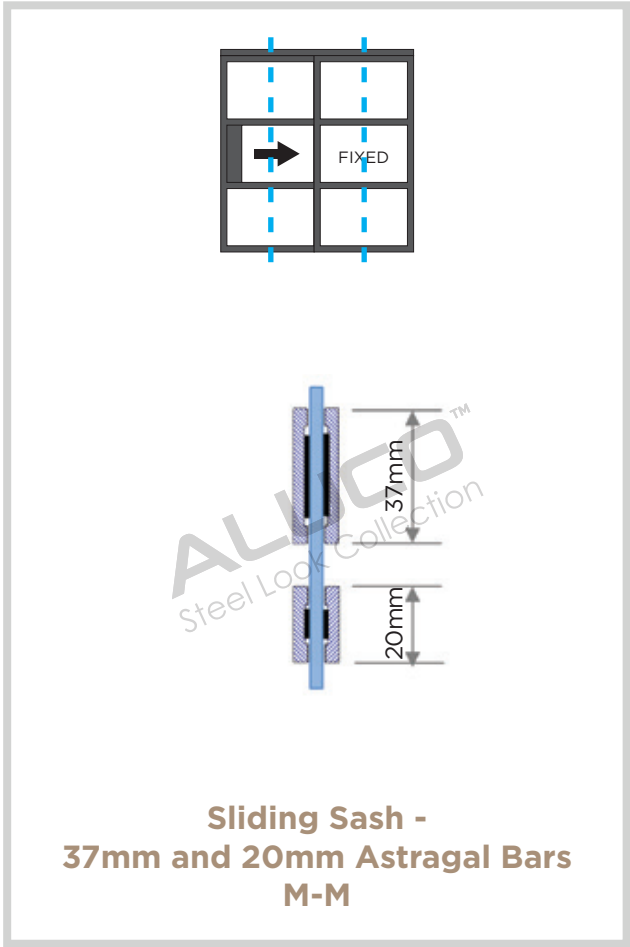
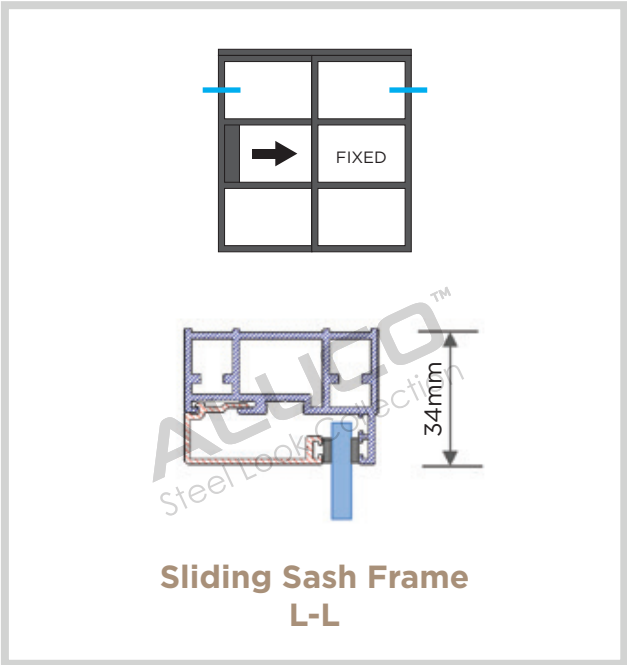
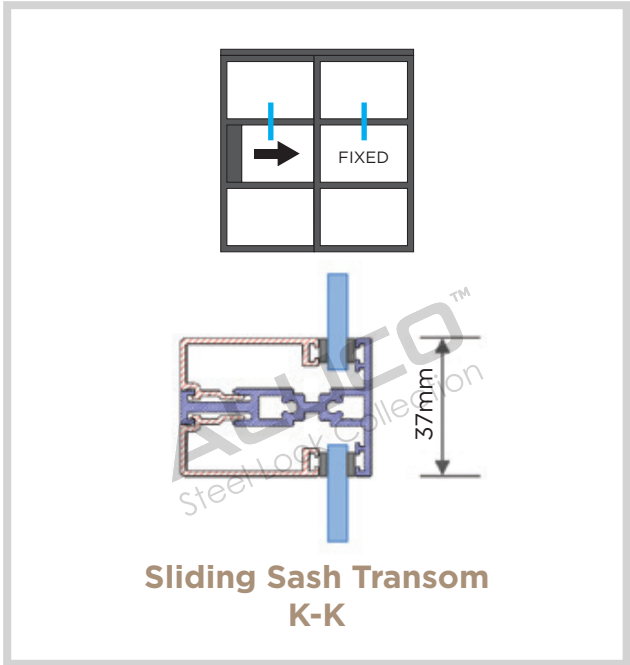

**NOTE** – Always depict Astragal Bar with dashed lines



# STYLE OPTIONS

## Single Hinged Doors & Sidelights

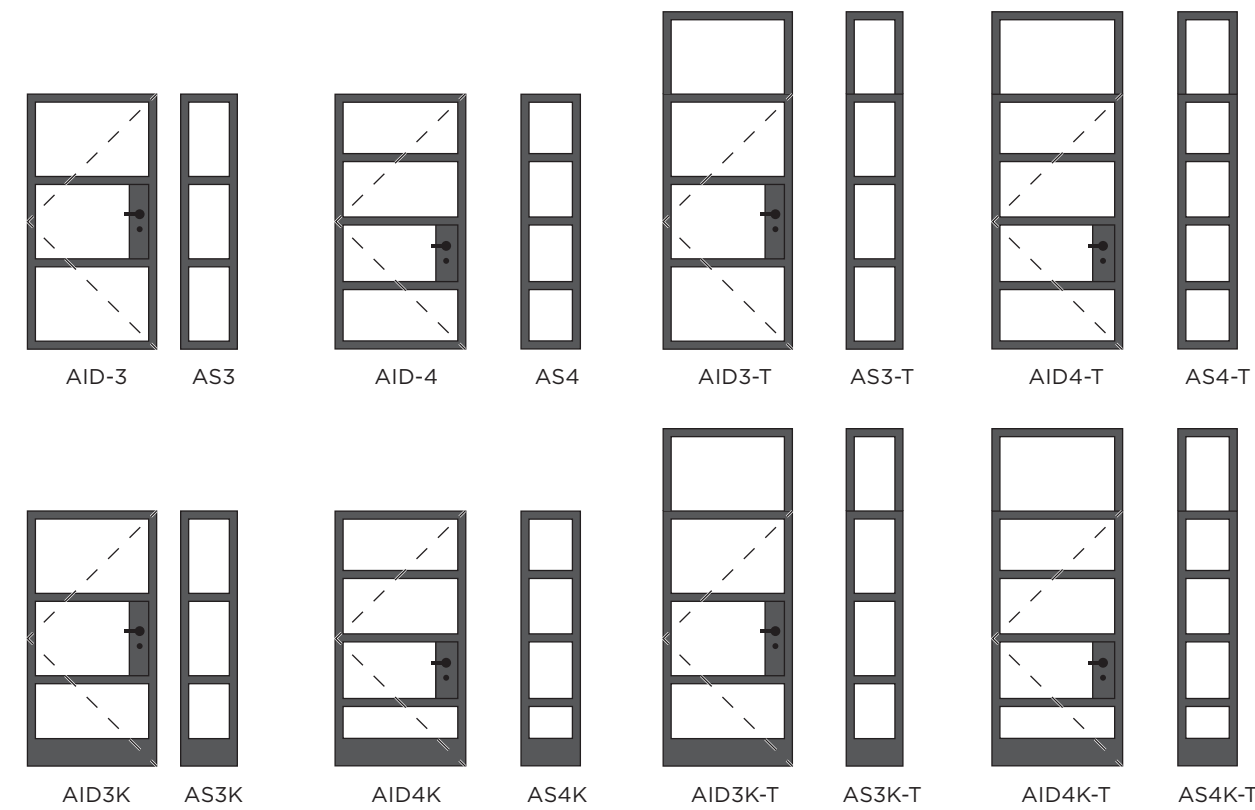

## Double Hinged Doors

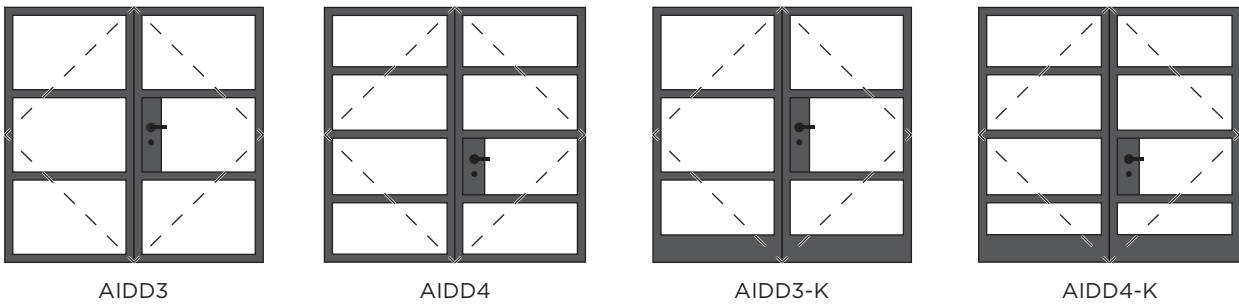

## Sliding Doors

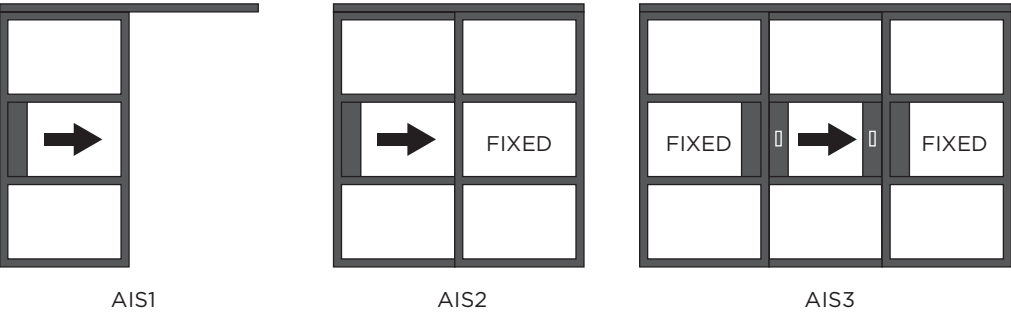

# MIN/MAX SIZES

## Aluco Interior Doors, Screens & Partitions Min/Max Sizes

Product	Min. Width	Min. Height	Max. Width	Max. Height
Single Door (Internal)*	600mm	1500mm	1000mm	2300mm
Double Doors (Internal)*	1200mm	1500mm	1900mm	2300mm
Partition Screens	300mm	300mm	3000mm	2500mm
Sliding Sash	900mm	1500mm	3500mm	2300mm

\*Max. Heights are based on the assumption that internal doors will be single glazed, if the door is internal but double glazed please refer to external max. heights.

Standard handle height is set at 1000mm from floor level, however depending upon height and style of the door the handle height can be positioned between 1000 and 850mm.









# The ALUCO Experience

See for yourself the exceptional quality and design of our interior doors, screens and partitions, discover our range of finishing touches and discuss your project with an experienced designer.

When you choose a product from the Aluco Collection, you're choosing a dedicated team, unrivalled product performance and an unsurpassed passion for quality.

Contact us to get in touch with your nearest Retail Partner

**T: 01480 436578**

**E: [info@aluco.co.uk](mailto:info@aluco.co.uk)**



@alucoaluminium



@AlucoAluminiumLtd



# ALUCO™

Steel Look Collection

(t) 01480 436 578 (e) [info@aluco.co.uk](mailto:info@aluco.co.uk)

 [@alucoaluminium](https://www.instagram.com/alucoaluminium)

[www.aluco.co.uk](http://www.aluco.co.uk)